

SAFETY INSTRUCTIONS

PLEASE READ THESE INSTRUCTIONS CAREFULLY AND SAVE THEM, AS YOU MAY NEED THEM AT A LATER DATE.

1. TURN OFF ELECTRICITY at main fuse box (or circuit breaker box) before beginning installation by switching circuit breaker off or removing fuse.
2. MIN 75 DEGREE C SUPPLY CONDUCTORS.
3. CONSULT A QUALIFIED ELECTRICIAN TO ENSURE CORRECT BRANCH CIRCUIT CONDUCTOR.
4. If in doubt about electrical installation, consult a licensed electrician

NEEDED TOOLS

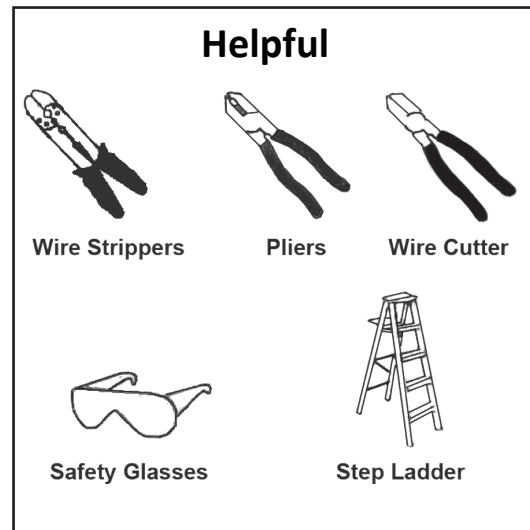
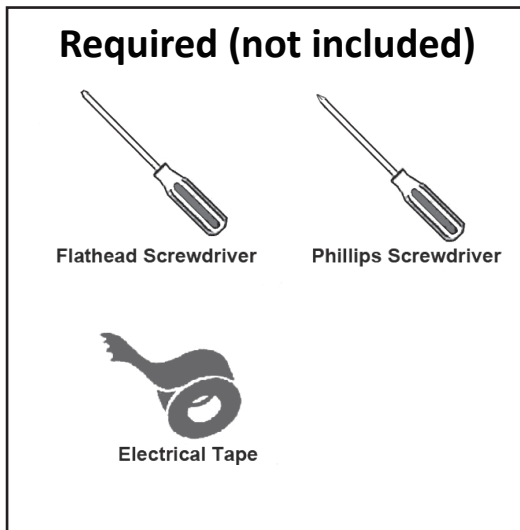

INSTRUCTIONS

Before beginning assembly and installation of product, make sure all parts are present. Compare parts with package contents list and diagram above. If any part is missing or damaged, do not attempt to assemble, install or operate the product. Contact customer service for replacement parts.

Estimated Assembly Time: 35 minutes

1. Fix the support nipple(B) with nuts (C) onto the mounting strip(A).

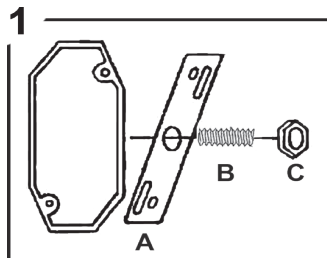

2. Attach mounting strip(A) to the junction box using outlet box screws(E).

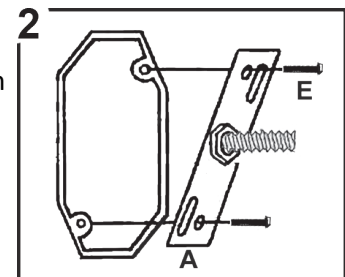

LED Outdoor Wall Light Installation Instructions

3. Remove the Diffuser(I) and Frame(J) from the Canopy(H) by loosening four thumb screws(K).

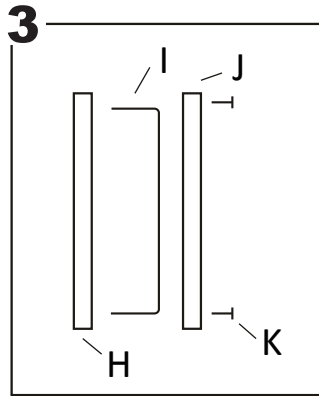

4. Strip 1/2 inch of insulation from wire ends. Twist stripped ends together with pliers black to black (power) and white to white (neutral). Attach copper wire to ground wire. Helpful Hint: If necessary,

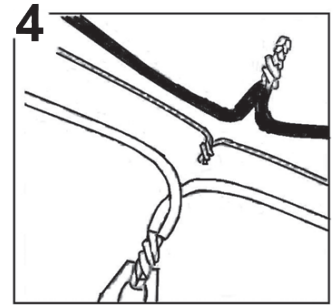

5. Attach wire nuts(D). Tape wire nuts(D) and wires together with electrical tape.

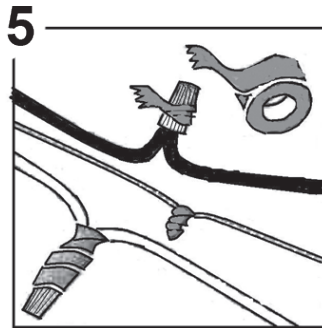

6. Attach the fixture to the ceiling by aligning the nipple that protrudes from the mounting strip(A) to the hole in the ceiling plate(H). Screw the cap nut(G) onto the protruding nipple until

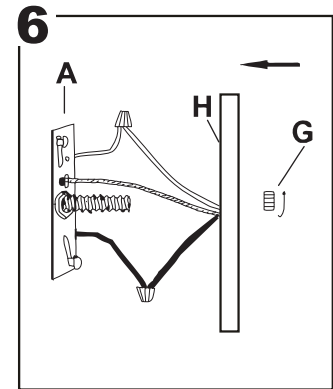

7. Set Diffuser(I) into frame(J). Position frame(J) over back canopy(H) and screw with four thumb screws(K).

