

Note: After the product base is fixture, choose the requested CCT and Power Percentage by dip switching.

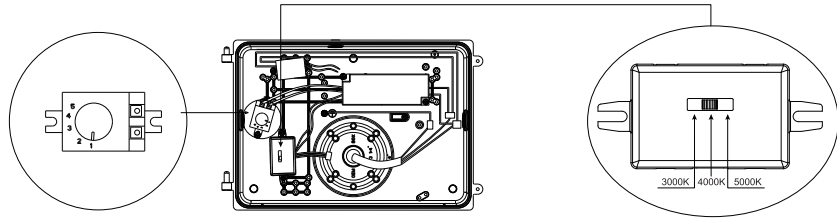

Gear	Power Percentage
1	20%
2	40%
3	60%
4	80%
5	100%

Note: The above installation is applicable to below fixtures.

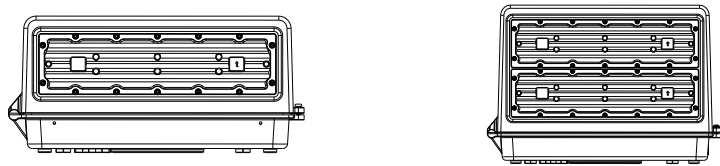

**Warning/Avertissement:**

MIN 75 °C SUPPLY CONDUCTOR  
 THIS PRODUCT MUST BE INSTALLED IN ACCORDANCE WITH  
 THE APPLICABLE INSTALLATION CODE BY A PERSON  
 FAMILIAR WITH THE CONSTRUCTION AND OPERATION OF  
 THE PRODUCT AND THE HAZARDS INVOLVED.

LES FILS D'ALIMENTATION 75 °C MIN  
 CE PRODUIT DOIT ÊTRE INSTALLÉ SELON LE  
 CODE D'INSTALLATION PERTINENT, PAR UNE PERSONNE  
 QUI CONNAÎT BIEN LE PRODUIT ET SON FONCTIONNEMENT  
 AINSI QUE LES RISQUES INHÉRENTS.

# LED Full Cutoff Wall Pack Instruction

**Application :**

Available in tunnel (except for motor vehicle tunnel), workshop, warehouse, factory, house, building exterior, etc.

**Caution :**

1. Can not use the electric generator to test the LED lamp;
2. Please abide by related country, regional and local law and regulations when install this fixture;
3. Please don't install the fixture when raining to lower the risk of electric shock and avoid the failure.

**Note :**

1. To avoid possibility of electrical shock or fire, the installation personnel must have professional electric knowledge;
2. Please wear gloves to avoid injury before installation;
3. If any smoke or spark of the wire happened, please turn off the power immediately and notify relevant personnel;
4. This fixture is available in outdoor usage, but the distance from fixture to ground should be more than 2m.

The installation of the product can be used when it is marked with "√".

**Installation I :**

1. Take out the light, and loosen the screws on the cover and take apart the fixture by the screwdriver. Pull off the quick connect terminal vigorously. (Fig. 1-1A&B)

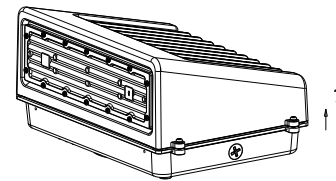

Fig. 1-1A

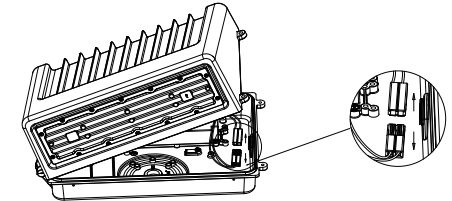

Fig. 1-1B

2. Drill an installation holes at the bottom of light, paste the EVA mat. (Fig. 1-2A&B)

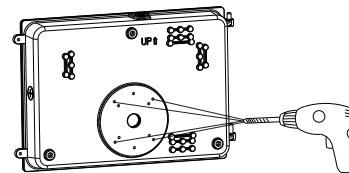

Fig. 1-2A

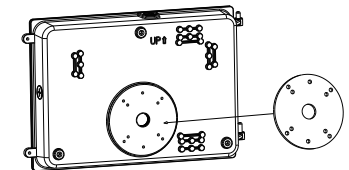

Fig. 1-2B

3. Loosen the plug on the bottom plate, then put the wiring through the hole, screw the bottom cover with junction box on the wall.(Fig. 1-3A&B)

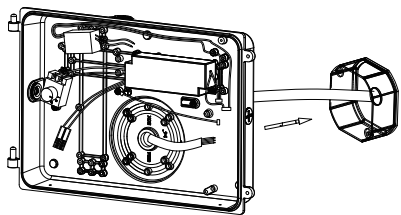

Fig. 1-3A

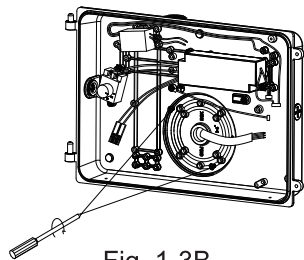

Fig. 1-3B

4. Make wiring connections per “Electrical Connections” section and make sure the good wire protection.(Fig. 1-4)

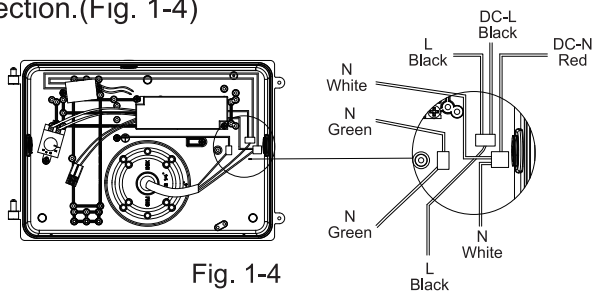

Fig. 1-4

5. Connect the quick connect terminal, then screw the fixture with bottom plate. (Fig. 1-5A&B)

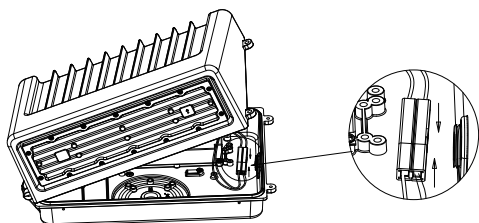

Fig. 1-5A

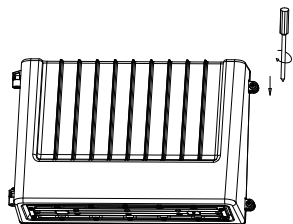

Fig. 1-5B

□ **Installation II :**

1. Take out the light, and loosen the screws on the cover and take apart the fixture by the screwdriver. Pull off the quick connect terminal vigorously. (Fig. 2-1A&B)

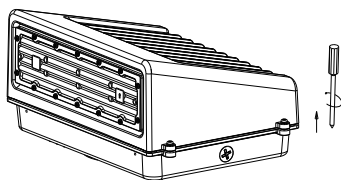

Fig. 2-1A

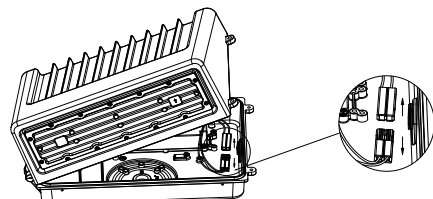

Fig. 2-1B

2. Rotate the three mounting kits to the proper angle. Put the fixture on the wall, make three marks according to the three mounting kits, then drill three holes for them. (Fig.2-2A)

Get rubber plugs into the holes, match the three mounting kits to the rubber plugs, then fix the fixture on the wall by screws with the spring washer and plain cushion. (Fig. 2-2B&C)

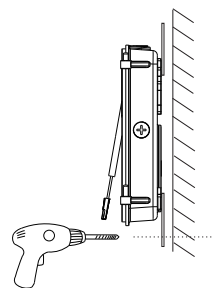

Fig. 2-2A

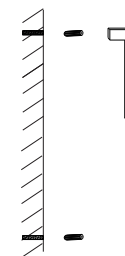

Fig. 2-2B

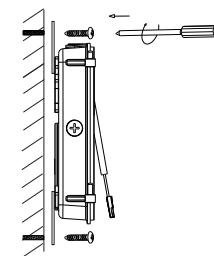

Fig. 2-2C

3. Make wiring connection from side and go through isolation treatment; Tighten the pipe on the luminaire. (Fig. 2-3A&B)

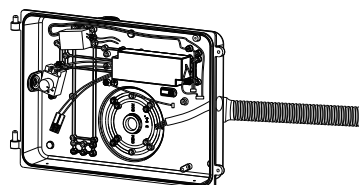

Fig. 2-3A

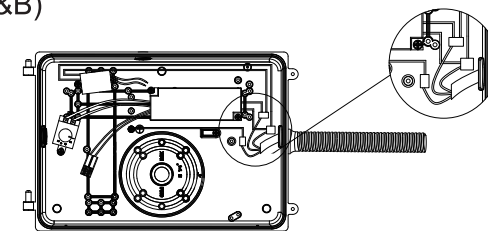

Fig. 2-3B

4. Connect the quick connect terminal, then screw the fixture with bottom plate. (Fig. 2-4A&B)

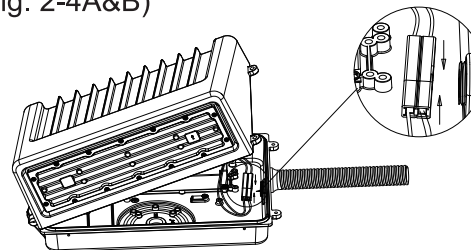

Fig. 2-4A

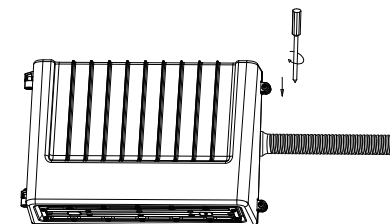

Fig. 2-4B

Standard wire:  
 L/live wire: Black\Brown;  
 N/null wire: White\Blue;  
 Ground wire: Green\Yellow-green;  
 DIM+: Purple;  
 DIM-: Gray.

DC ACL: Black  
 DC ACN: Red  
 DC 12+: Red  
 DC 12-: Black